

TF1700

Your best choice for outdoor access control

8.000 Fingerprint Available Now



TF1700 is one of the world's smallest Ethernet connection-based fingerprint terminals, used for access control and time attendance features, with IP65 waterproof housing.

With its IP65 rated rugged waterproof and dustproof structure, TF1700 offers extra durability in harsh conditions such as outdoor environments. It is specially designed for standalone applications such as house, office, shop, garage, factory and others.

The 2013 version of TF1700 is equipped with a sensor cover to protect the optical reader and updated with new firmware that supports ZKAccess3.5 management software which has versatile features and powerful functions.



Rugged Structure for Outdoor Installation and Extra Durability

- IP65 rated waterproof and dustproof structure



Slim and Elegant Design

- One of the world's smallest fingerprint terminals
- Sleek and slim design for narrow spaces



Fast and Accurate Fingerprint Algorithm

- 1 touch a-second user recognition
- Store 3,000 fingerprint templates, 30,000 cards and 100,000 transactions



Easy Installation and Connectivity

- Wiegand input & output
- Network interface by TCP/IP or RS485



Full Access Control Features

- Anti-passback
- Access control interface for 3rd party electric lock, door sensor, exit button, alarm and doorbell



Easy Operation and Management

- Work without computer
- OLED, buzzer, 3x5 keypad
- Built-in keypad and RF card reader for multi-modal authentication (Fingerprint/PIN/Card)

Specifications

Fingerprint Sensor	Infrared detection fingerprint sensor
Algorithm Version	ZK Finger 10.0
Communication	TCP/IP, RS485, USB Host
Fingerprint Capacity	3,000 Fingerprints(8,000 Optional)
Card Capacity	30,000 Cards
Log Capacity	100,000 Transactions
RF Card	EM(standard)/Mifare(optional)
Authentication	Finger/PIN/Card
Wiegand Signal	Wiegand input&output
Ingress Protection Rate	IP65
Display	128 x 64 OLED
Keypad	3 x 5 keypads & doorbell
Sound and Interface	Buzzer and multi-color LED
Operating Voltage	12VDC 3A
Operating Temperature	-10 °C~50 °C (14°F ~ 122°F)
Dimension	62.5mmx185mmx41.5mm (WxHxD)

Optional Accessories



FR1200



RFID Reader



Exit Button



Electric Lock

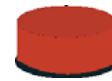

Alarm



Sensor

Configuration

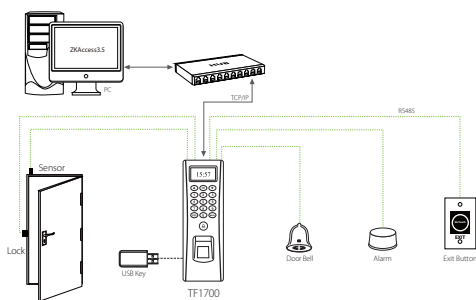

Dimensions (mm)

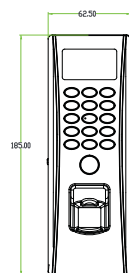
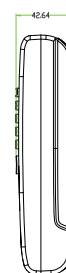

ZKTeco Inc.
 ZK Mansion, Wuhe Rd, Gangtou, Bantian, Buji Town,
 Longgang District, Shenzhen China 518129
 Tel: 86-755-8960 2345/46/47/48
 E-mail: sales@zkteco.com
 www.zkteco.com

Global Offices:
 USA: + 1 732-412-6007
 EU: +34 916532891
 Brazil: +55 31 2515-8326
 Thailand: +66-027199154
 Mexico: +52-55-52928418

South Africa: +27 12 259 1047
 Egypt: +201110444134
 Dubai: +971 4 6091 310
 India: +91 8123536788
 Indonesia: +62 21 2921 8949

Vietnam : +84-0169-5813007
 Philippines: +63 9084118832
 Russia: +8 915 178-46-81